

Coastal

MOTORHOMES & CARAVANS LTD.



The home of

**HILLTOP**
Caravans

STANDARD FEATURES

COASTAL MOTORHOMES & CARAVANS ARE PROUD TO PRESENT TO YOU ONE OF AUSTRALIA'S FINEST CARAVANS.

Named after famous Australian mountains and slopes, Hilltop Caravans take great pride in every aspect from design to build. They know from first-hand experience what works, what doesn't, and how to take advantage of every inch of interior space.

Hilltop Caravans ensure that their range of caravans are custom built, using locally sourced materials and componentry, to the highest standard. This includes quality, modern fittings, optional upgrades and more, providing a strong and durable product. When ordering your new caravan you can choose from a range of top-quality interior finishes for the floor, cabinets, benchtop, splashback and upholstery.

HILLTOP CARAVANS ARE SELF CONTAINED & COME STANDARD WITH THESE QUALITY FEATURES

- Single/Tandem axle with rocker suspension
 - 15" wheels
 - Fibreglass roof, composite sides & checker plate surround
 - Camec main door with aluminium security mesh
 - LED outside grab handle & strip light around the step
 - External speakers
 - Annex lights on both sides
 - Fold down picnic table
 - Gas bottle toolbox with 2x 9kg gas bottles
 - 2x tunnel boots (front & rear) with interior light*
 - 200L fresh water tank
 - 100L grey water tank (self contained certified)
 - 40mm rigid pipes
 - 1x 200W solar panel with 30amp solar regulator
 - 2x 120amp house batteries
 - Safety Dave rear view camera & monitor
 - Manual slide out step & drop jacks
 - Dometic/Ranger rollout awning
 - Sidewinder jockey wheel
 - Water tap to main frame
 - External gas bayonet
 - Electric brakes & breakaway safety device
 - Island bed with under bed storage
 - Thetford 190L 3-way fridge
 - Full spacious ensuite with shower, separate toilet & handbasin/vanity compartment
 - Swift gas/electric cooker with grill & fan forced oven with range hood
 - 28L Swift hot water service
 - Synthetic leather/fabric upholstery
 - Ranger vents & windows, double glazed with screens & blinds
 - Kitchen with water filter tap to kitchen sink
 - Full extension ball bearing runners for all drawers
 - 2-way switching system (bedroom & seating area)
 - USB charging points
 - 25L microwave
 - 25/30amp battery charger
 - Bulkheads throughout with LED lighting
 - Radio with DVD & bluetooth function
 - Washing machine*
 - Air conditioning*
 - Wifi router
 - Smart TV
 - 2kw diesel heater
- * not all models

"I haven't been everywhere... but it's on my list!"

HILLTOP CONSTRUCTION

HILLTOPS' FOLLOW YOU WITH LUXURY AND COMFORT

Hilltop build their caravans using Australian FP Chassis made from Australian RHS steel, cold galvanised. Framing consists of 42x19mm meranti timber spaced 200-270mm apart for maximum strength and lightness. Curved wood is used to give the front framing extra strength. Plywood flooring comes standard with thermal interior vinyl and exterior painted membrane. A traditional cabinet build is utilised, fixing the cabinetry from the outside before the exterior is finished. It is fixed into all corners of the van giving the van extra structural strength. All cupboards have an edge trim to ensure they're finished to the highest standard possible, and have piano hinges for extra strength.



FEATHERTOP

5.4M (5440MM) | 6.0M (6000MM) HILLTOP FEATHERTOPS

Strength and performance while delivering a luxurious living space, Hilltop Feathertop models feature upscale amenities at an attractive price. Models vary from 17'6" to 19'6" in length, single axle to tandem axle, with various layouts available.

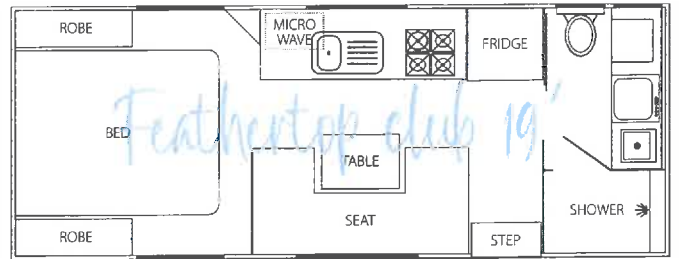
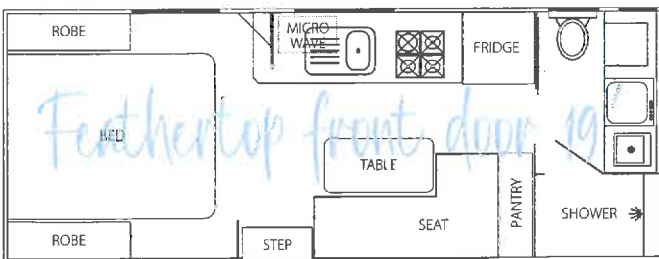
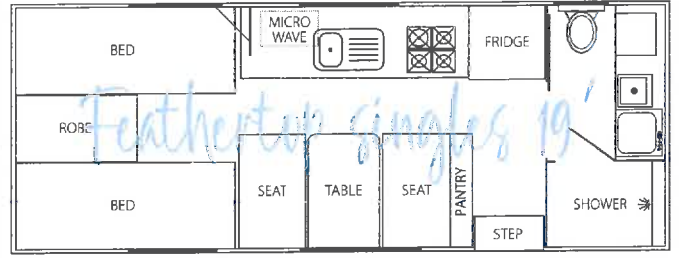
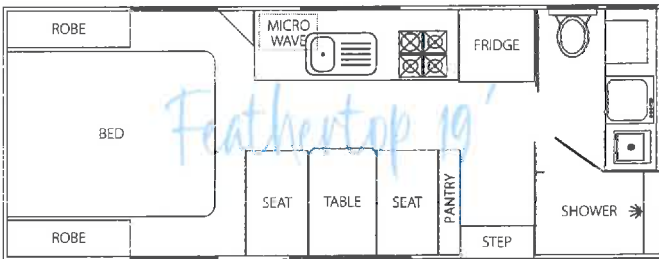
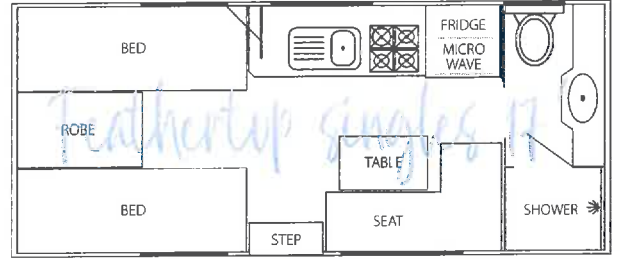
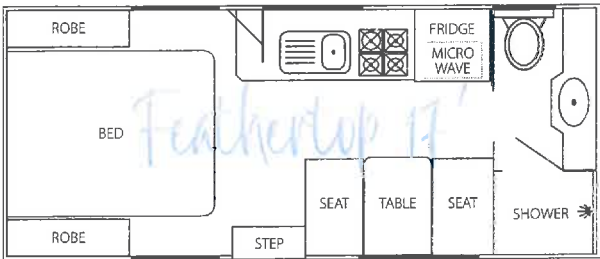
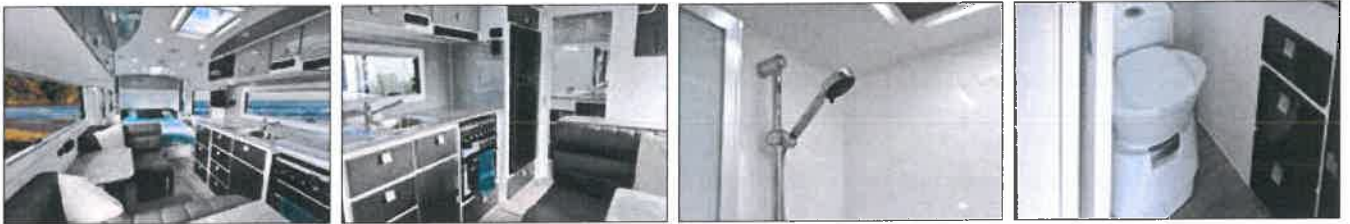

17' Models

- Berths: 2
- Tare: 2040
- GVM: 2700
- Ball weight: 140kg
- Overall length: 7440mm

19' Models

- Berths: 2-3
- Tare: 2360
- GVM: 3200
- Ball weight: 160kg
- Overall length: 8000mm

"Not all who wander are lost!"

SLIDEOUTS : SADDLEBACK, OLYMPUS & PADDINGTON

6.6M (6614MM) HILLTOP SADDLEBACK

Combining Hilltop Caravan's legendary comfort, luxury, quality, and value, the Hilltop Saddleback club lounge is sure to set a new industry standard.

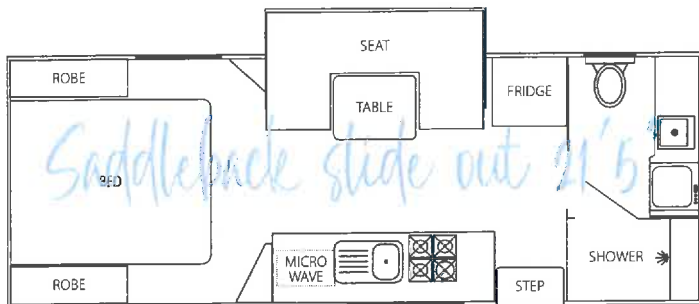

Specifications

- Berths: 2-4
- Tare: 2900
- GVM: 3500
- Ball weight: 180kg
- Overall length: 8614mm

6M (6030MM) HILLTOP OLYMPUS CARAVAN WITH FRONT CLUB LOUNGE

Olympus comes with slide out which creates a spacious bedroom area. A large front lounge with hydraulic table to relax and enjoy.

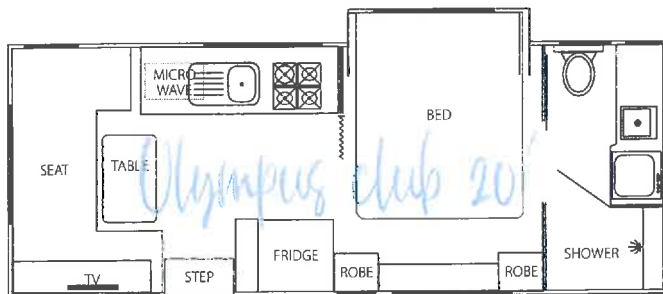

Specifications

- Berths: 2-4
- Tare: 2700
- GVM: 3500
- Ball weight: 120kg
- Overall length: 8030mm

6.7M (6705MM) – 7.5M (7498MM) HILLTOP PADDINGTON

Hilltop Paddington comes with a spacious bedroom area in the middle with 2 single beds or spacious slide out bedroom. Slide out bedroom version equipped with attractive set of cabinetry and a pop up HD TV. Packed with extra features it boasts a spacious club lounge with hydraulic table which sits on a raised floor illuminated by a LED strip lighting.

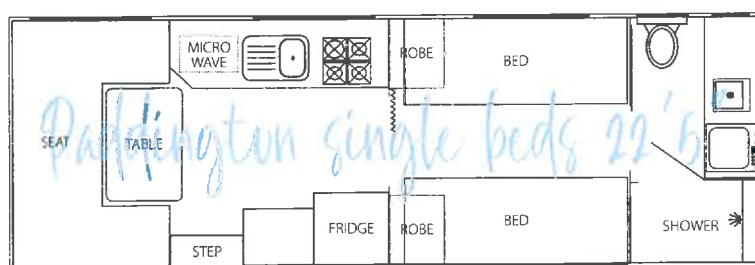

Specifications

- Berths: 2-4
- Tare: 3000
- GVM: 3500
- Ball weight: 160kg
- Overall length: 8705mm

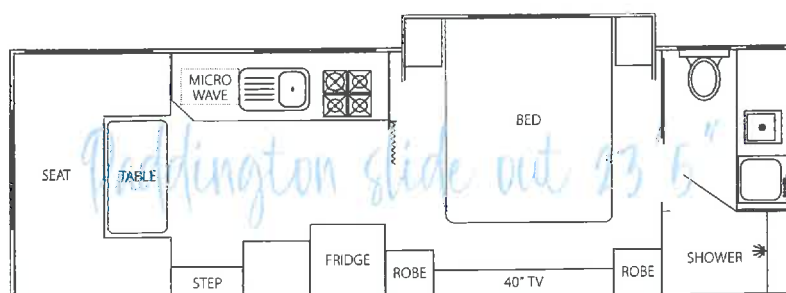

Specifications

- Berths: 2-4
- Tare: 3100
- GVM: 3500
- Ball weight: 220kg
- Overall length: 9498mm

GRAMPIAN, MISTY, HOTHAM & THREDBO

6.7M (6705MM) HILLTOP GRAMPIAN

A revolution in luxury, style and comfort, the Hilltop Grampian is in a class of its own. This centre door layout is equipped with a spacious ensuite and plenty of storage.

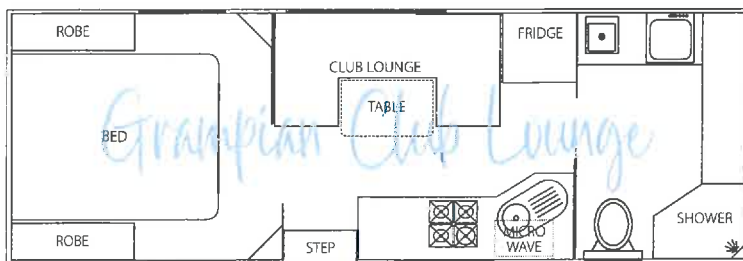

Specifications

- Berths: 2-4
- Tare: 2540
- GVM: 3200
- Ball weight: 180kg
- Overall length: 8705mm

HILLTOP MISTY (6190MM)

Misty takes all the features you love and combines them into one premium caravan. It has an extra large bathroom and the angled kitchen sink and microwave shelf allows for more bench space. And it has lots of storage space!

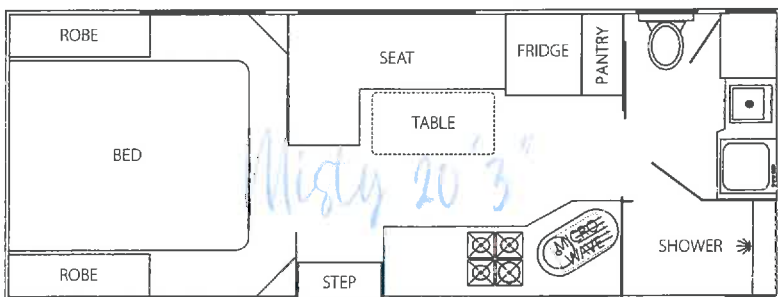

Specifications

- Berths: 2-4
- Tare: 2700
- GVM: 3200
- Ball weight: 200kg
- Overall length: 8190mm

6.4M (6454MM) HILLTOP HOTHAM

Similar to the Feathertop but offering a little more length and space.

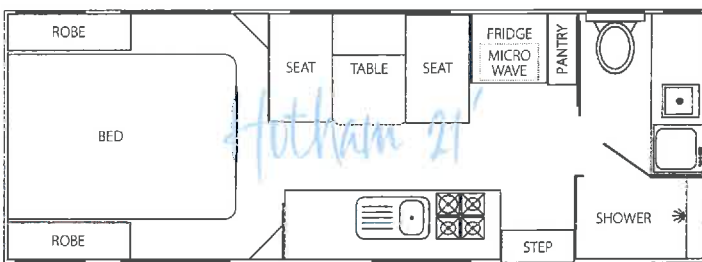

Specifications

- Berths: 2
- Tare: 2440
- GVM: 3200
- Ball weight: 180kg
- Overall length: 8454mm

7M (7020MM) HILLTOP THREDBO CARAVAN WITH MIDDLE BATHROOM

HillTop Thredbo is a 23' middle bathroom caravan. Bedroom and living area is separated by a cavity sliding door. Spacious angle kitchen fitted with fan forced oven and large club lounge at rear makes it comfortable to sit and relax.

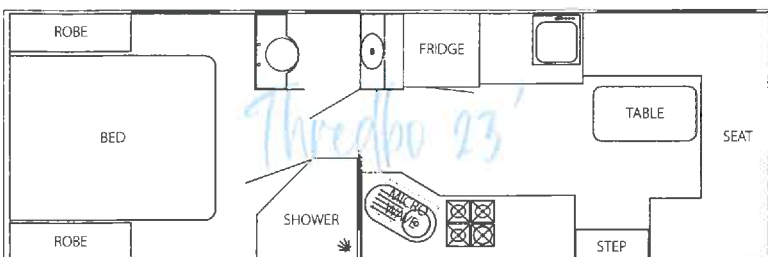

Specifications

- Berths: 2-4
- Tare: 2700
- GVM: 3500
- Ball weight: 240kg
- Overall length: 9020mm

BUNKS : STRZELECKI, ASPIRING & KOSCIUSZKO

5.4M (5350MM) STRZELECKI

With 2 or 3 large bunks, shower and toilet, full oven, large fridge, L shaped dinette with adjustable table that can convert to another bed, Hilltop Strzelecki is ideal for families who want to get out and explore the outdoors.

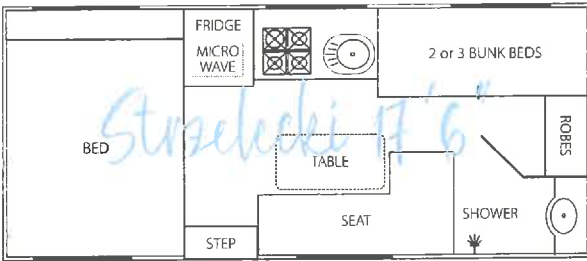

Specifications

- Berths: 4-5
- Tare: 2100
- GVM: 2700
- Ball weight: 140kg
- Overall length: 7350mm

6.7M (6706MM) ASPIRING

The Hilltop Aspiring with rear door, bunks and a full shower. What's not to like?

Huge seating for all the family

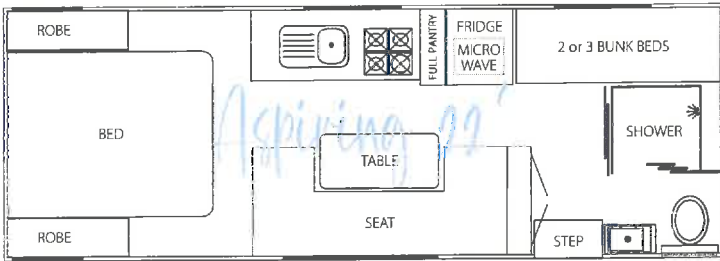

Specifications

- Berths: 4-5
- Tare: 2700
- GVM: 3500
- Ball weight: 140kg
- Overall length: 8706mm

6.5M (6528MM) | 6.8M (6833MM) KOSCIUSZKO

Hilltop Kosciusko (ko-zee-o-skow) is the ultimate family van with quality construction and spacious living, featuring premium amenities and abundant storage with ample space for all family members.

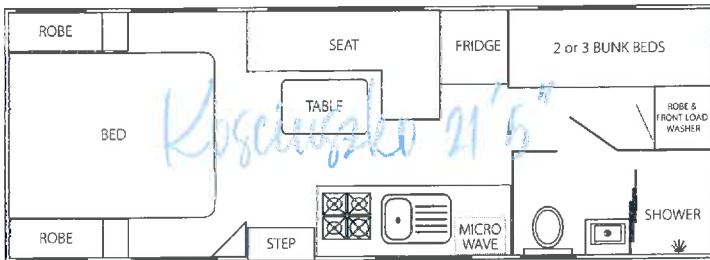

Specifications

- Berths: 4-5
- Tare: 2700
- GVM: 3500
- Ball weight: 240kg
- Overall length: 8528mm

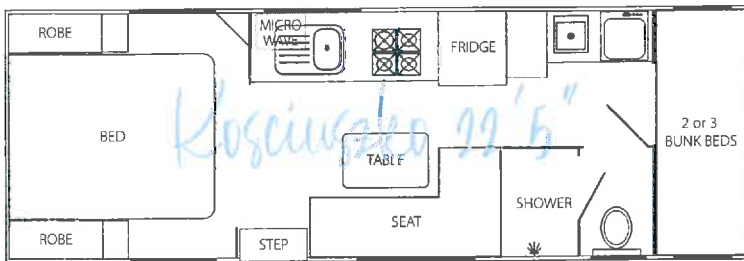

Specifications

- Berths: 4-5
- Tare: 2700
- GVM: 3500
- Ball weight: 240kg
- Overall length: 8833mm

"Of all the paths you take in life... make sure a few of them are dirt!"

PERSONALISE YOUR HILLTOP!

PERSONALISE & TAILOR YOUR HILLTOP CARAVAN WITH THESE OPTIONAL UPGRADES & EXTRAS TO SUIT YOUR LIFESTYLE

- Inverter options
- Lithium battery options & upgrades
- Solar upgrades
- ESC unit
- Dometic compressor fridge
- External shower
- Sirroco fan
- Front & rear work lights
- Additional grey tank with digital gauge
- Front stoneshield (supply & installation)
- Witi electric brakes & security
- 16" wheels & MPC
- Jerry can holder
- DO35 hitch
- Checker plate protection for pipes
- Underslung spare wheel carrier
- Double step
- Electric step
- Cruisemaster suspension
- Country road suspension brakes
- Dexter sway control
- Slide out kitchen
- Bike rack options
- And much more!



"Home is where you park it!"

Coastal

MOTORHOMES & CARAVANS LTD.

23 Mill Road, Coastlands, Whakatāne 3120
0800 737 010 | info@coastalmotorhomes.co.nz
www.coastalmotorhomes.co.nz  

FOR ALL YOUR STORAGE, SERVICE, PARTS & ACCESSORY REQUIREMENTS

Installations | Repairs & Fault Finding | Satellite | Solar, Batteries & Accessories | Plumbing | Awnings & Screens | Bike Racks
Insurance Repairs | Accessories | Appliances | Chassis | Covers & Mats | Electrical & Lighting | Hardware & Furniture | Hatches & Vents
Sanitation | Windows & Doors | Heating, Water & Air | Self Containment & Gas | TV & Audio | and more...

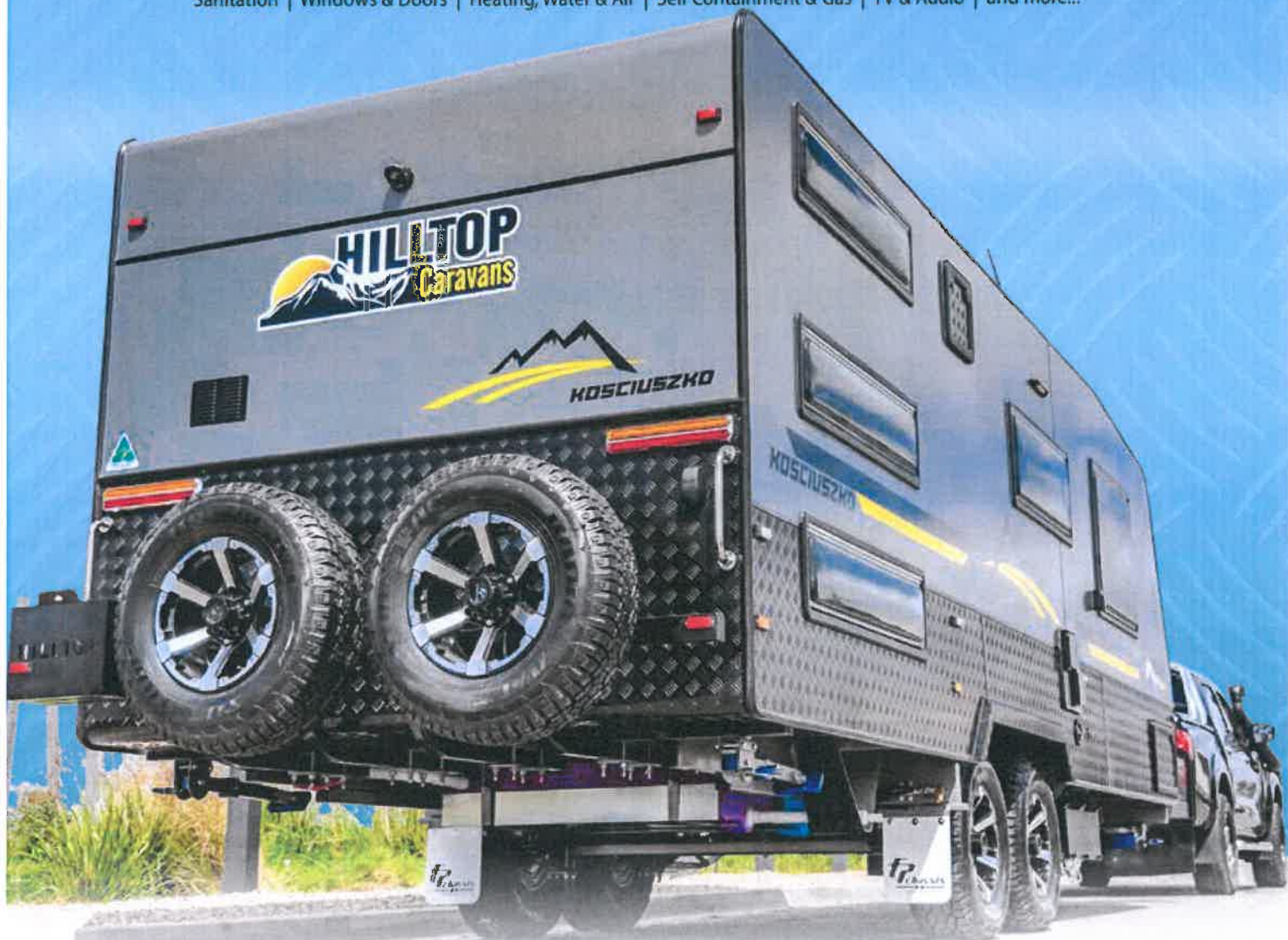

 **HILLTOP**
Caravans